



Powerful Solutions

# EagleEyes CCTV

## SECURITY SOLUTIONS AND TECHNOLOGIES

### Caixa de Proteção de Aço Inox 304/316L Anti-Corrosão IP68

As Caixas Anti-Corrosão EagleEyes EE-H316/304SX/SW foram desenvolvidas e produzidas em aço inox 316L para proteção anti-corrosão marítima e ácidos corrosivos. Este modelo pode ser utilizado em locais que contenham gases e ácidos corrosivos; e também em ambientes marítimos tais como: Plataformas off-shore, navios, beira-mar, etc. O modelo anti-corrosão EE-H316/303S/SW possibilita instalar câmeras de CCTV e lentes varifocais ou motorizadas, e possui protetor solar. (Limpador, Suporte, ventilador e aquecedor, e bomba d'água opcionais)



EE-H316/304SW-SS  
Com Limpador  
EE-H316/304S-SS  
Sem Limpador



EE-H316/304SX-SS01  
Tamanho pequeno

#### DESCRIÇÃO BÁSICA

- Construído em aço inox 316L (Aço 304 opcional)
- Exterior *eleto-polished* e tratamento anti-corrosão nas partes internas
- Proteção contra interperes padrão IP68
- Caixa de proteção compacta
- Opcionais: Limpador, aquecedor/ventilador e bomba d'água



Suporte Aço Inox Opcional  
EE-SP316/304-SS



Suporte Aço Inox Opcional  
EE-SP316/304-SS1

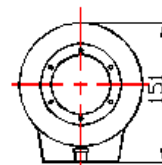
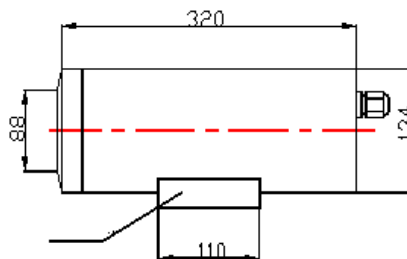
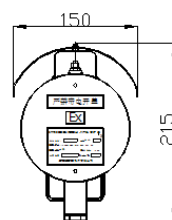
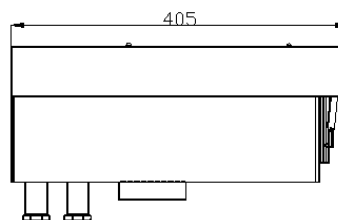

## SECURITY SOLUTIONS AND TECHNOLOGIES

### Caixa de Proteção de Aço Inox 304/316L Anti-Corrosão IP68

#### Technical Specifications

Models		EE-H316SW-SS (316L with wiper) EE-H316S-SS (316L without wiper) EE-H304SW-SS (304 with wiper) EE-H304S-SS (304 without wiper)	EE-H316S-SS01 (316L small housing) EE-H304S-SS01 (304 small housing)
Basic Parameter	Manufacturers Standard	Enterprise & Industrial Standard	
	Configuration Mode	Front and rear caps with threaded flameproof joints and silastic gasket	
	Ex-proof mode	IP68	
	Operating environment	Places with corrosive air or substance such as acid, alkali, salt, etc	
	Operating temperature (°C)	(-)25~(+)60	
	Relative Humidity	≤95% (+25°C)	
	Cable entries	2 corrosion-proof cable entries, inner hole dia.φ10	
Mechanical	Construction	316L stainless steel (304 Stainless Steel optional)	
	Wiper	Included	No
	Wiper's rotate speed (r/s)	1	No
	Electric motor	Permanent-magnet D.C. motor decelerates with gear	
	Transmission structure	Lubricated all-wheel inner parts	No
	Visor glass dimensions	φ75 (mm) Tempered Glass	
	Dimensions (L×W×H) mm	405×150×215	320×134×151
	Inside dimensions (mm)	φ125×330	φ100×280
	Weight (kg)	5	2
	Built-in Controller	Controlling Device	AVR singlechip with RSIC kernel
Controlling Interface		Switch signal	
Voltage (V)		12 V DC/24VAC	
Current (A)		300	
Power Supply	Voltage (V)	12V DC/24V DC/220V AC 50/60Hz	
	Current (A)	1/0.5/0.1	
Others	Sunshield	Fitted as standard	Optional
	Built-in Power supply module	Optional	
	Inner heating	Optional	
	Cable requirement	Power supply: 2X1.0 mm <sup>2</sup> (24V DC) / 2×0.75 mm <sup>2</sup> (220V AC) Communication: Shield 2X0.75 mm <sup>2</sup> Video: 75Ω	

#### EagleEyes Explosion-Proof CCTV Equipment Stainless Steel 316L



EE-HX316-EX-SS



EE-RC316-EX-SS



EE-PT316-EX-SS



EE-PTZ316-EX-SS